

FRONT ELEVATION
SCALE: 1" = 8' 0" (1:100)

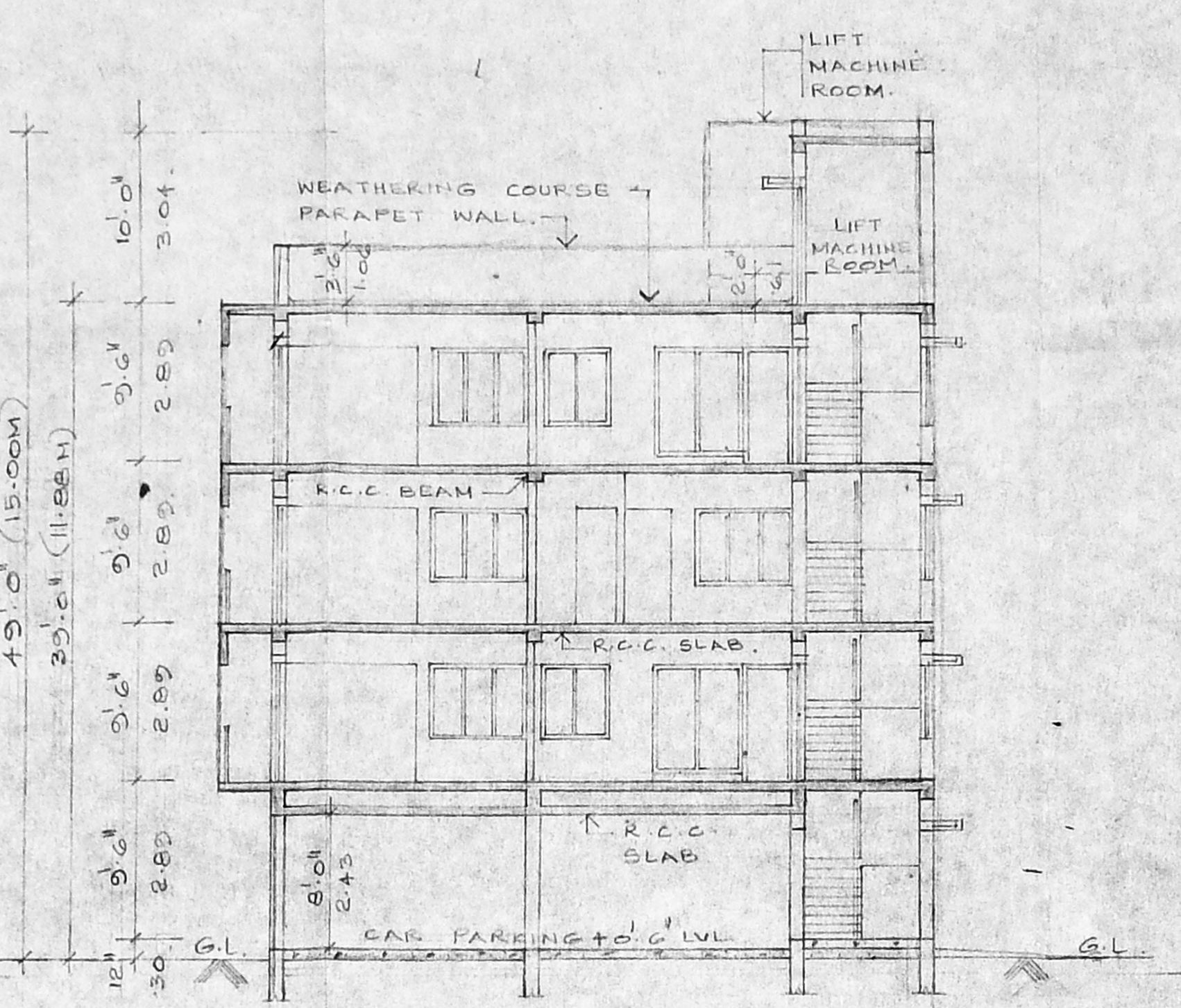

SECTION ON "AA"
SCALE: 1" = 8' 0" (1:100)

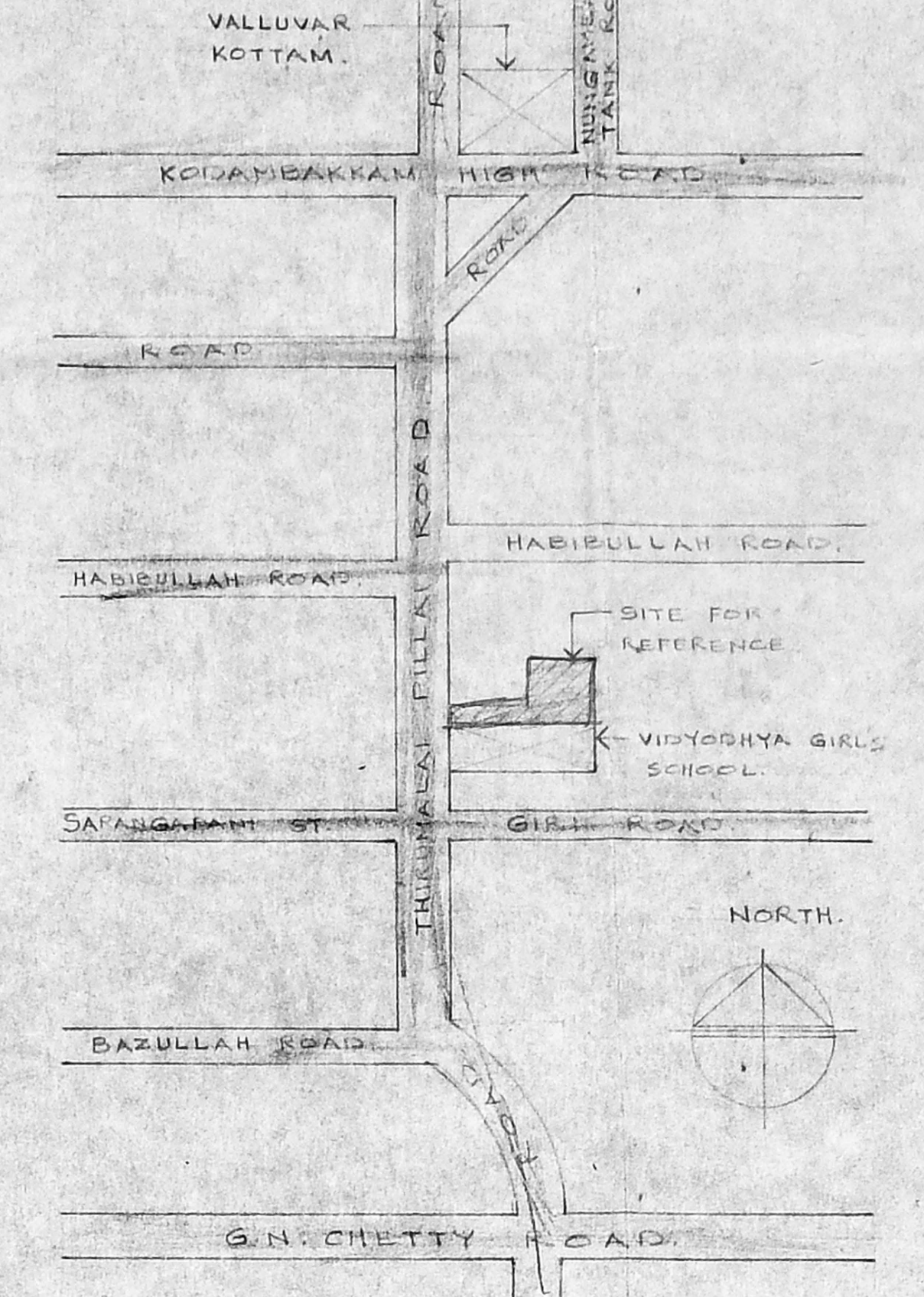

KEY PLAN
NOT TO SCALE

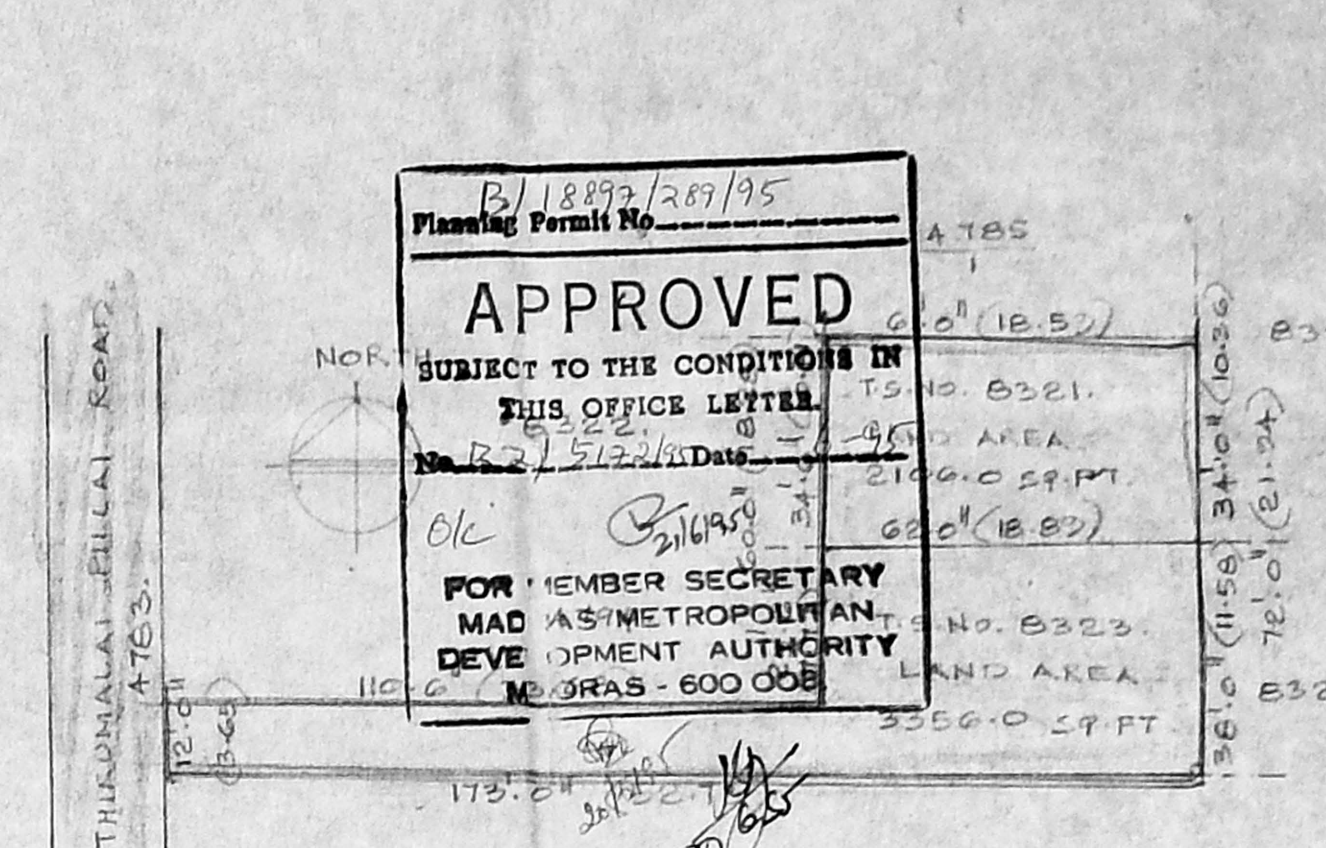

AS PER PATTA
SCALE: 1" = 32' 0" (1:100)

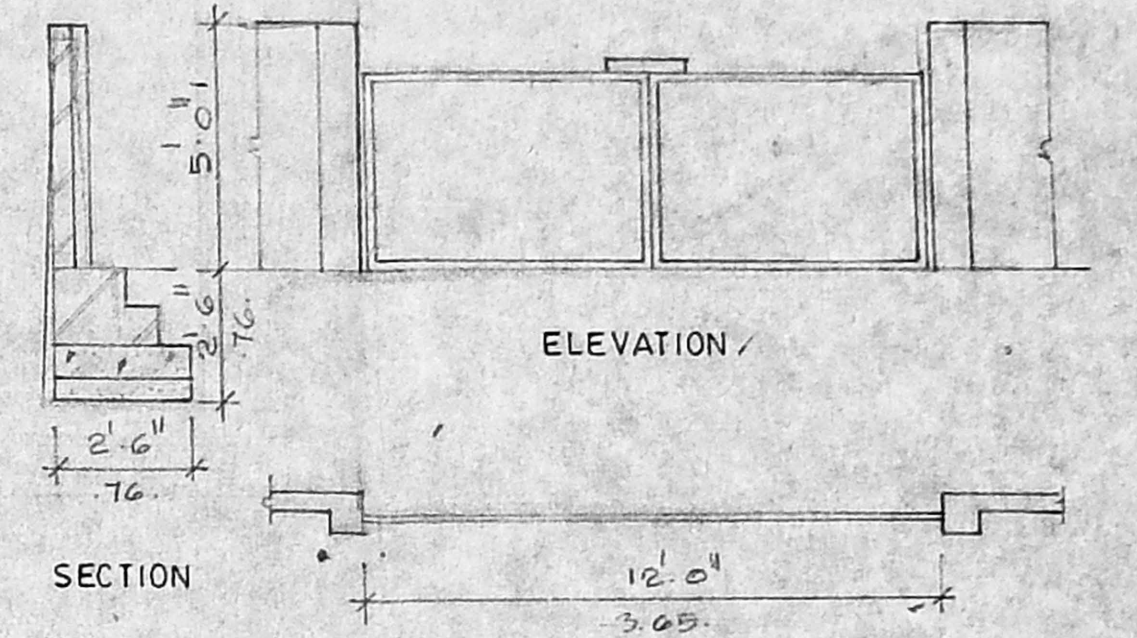

ELEVATION

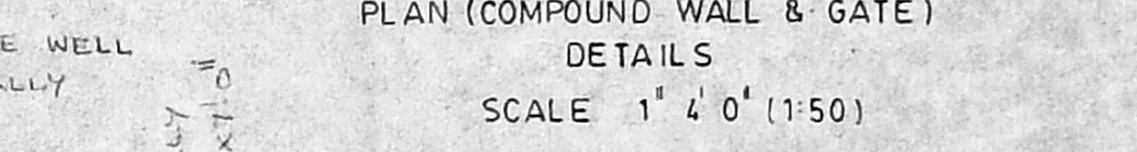

SECTION

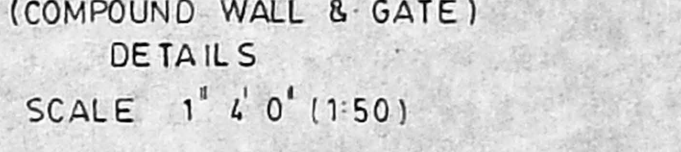

PLAN (COMPOUND WALL & GATE) DETAILS

SCALE: 1" = 4' 0" (1:50)

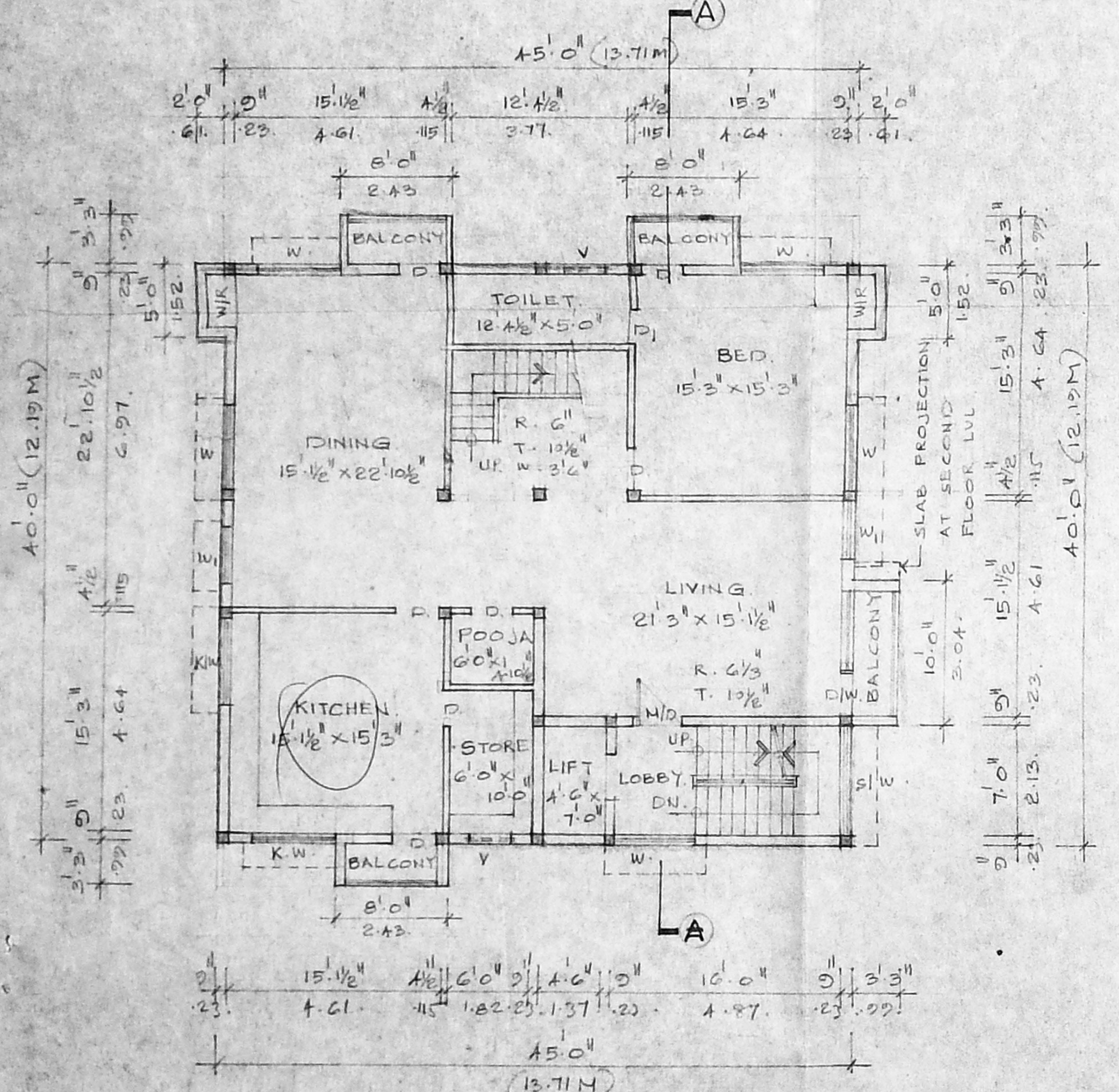

FIRST FLOOR PLAN
SCALE: 1" = 8' 0" (1:100)

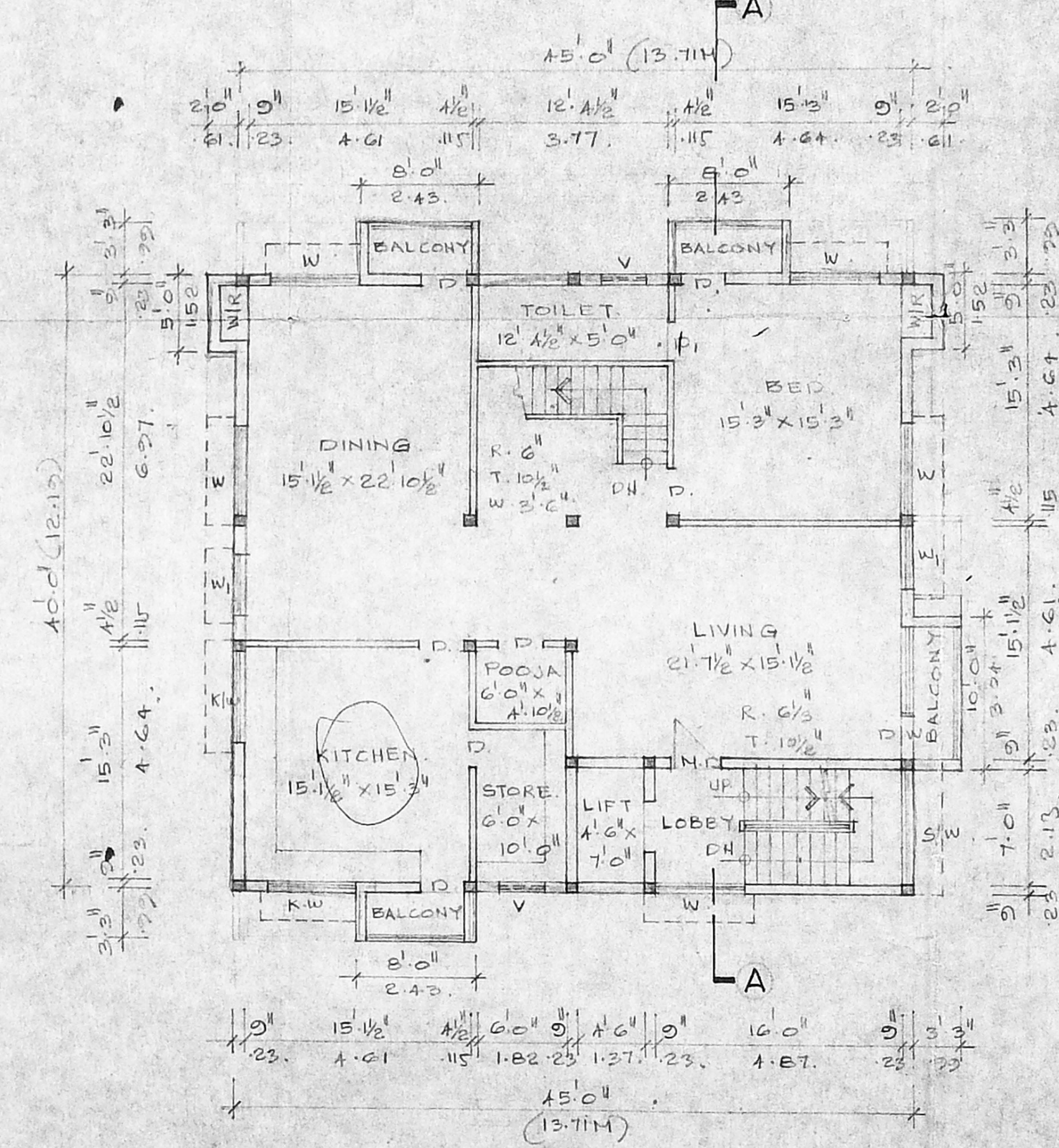

THIRD FLOOR PLAN
SCALE: 1" = 8' 0" (1:100)

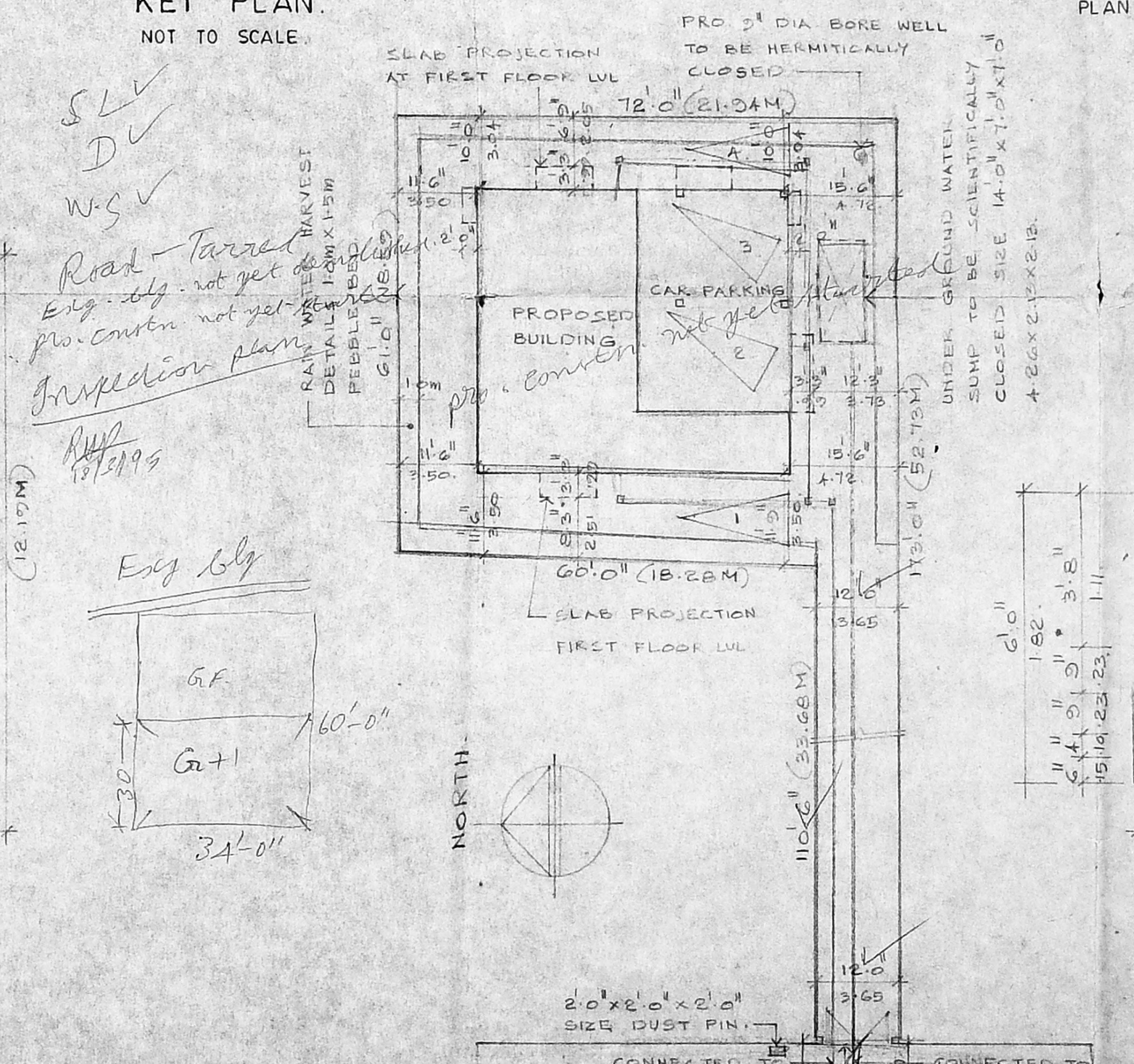

SITE PLAN
SCALE: 1" = 16' 0"

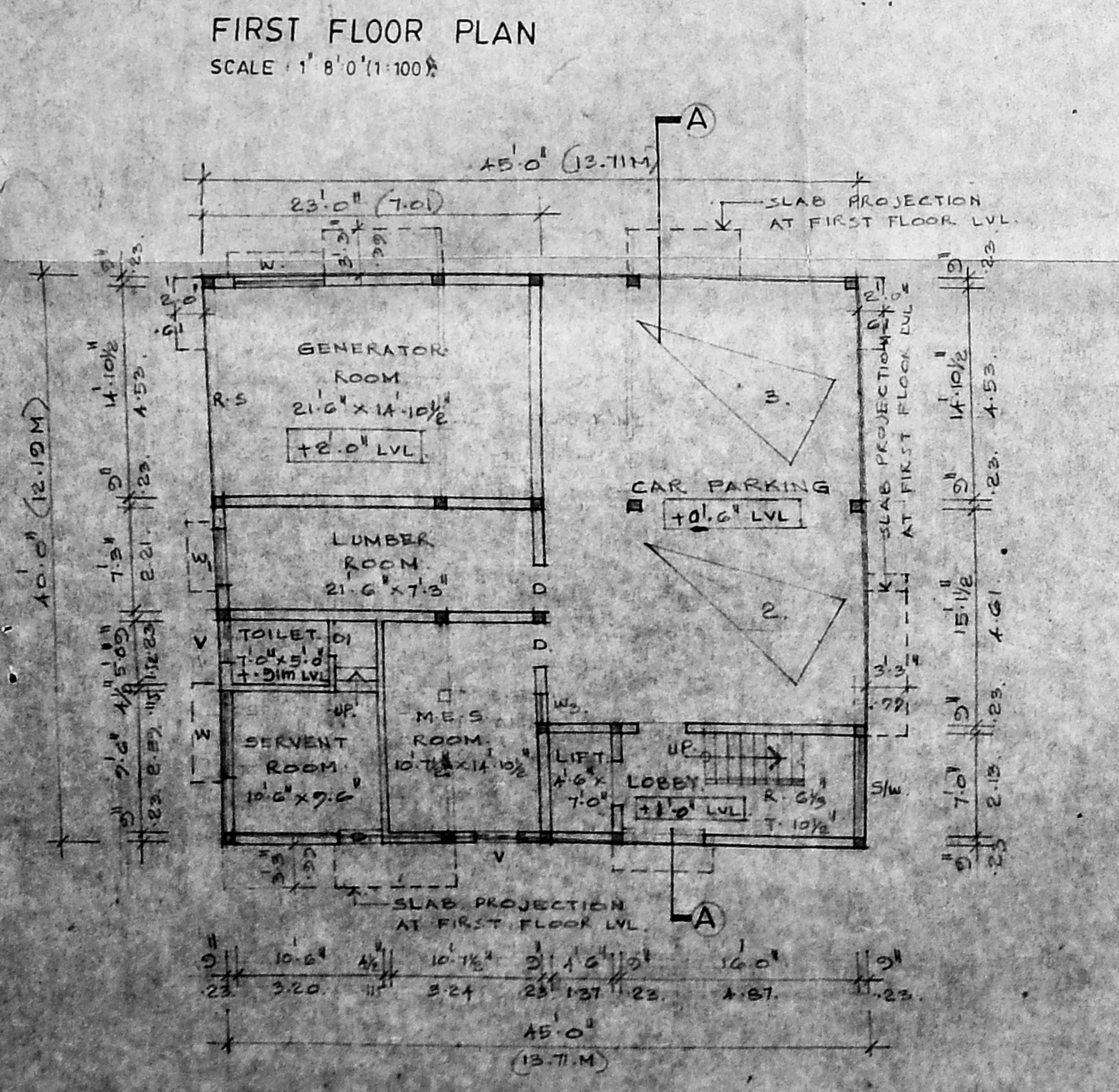

GROUND FLOOR PLAN
SCALE: 1" = 8' 0" (1:100)

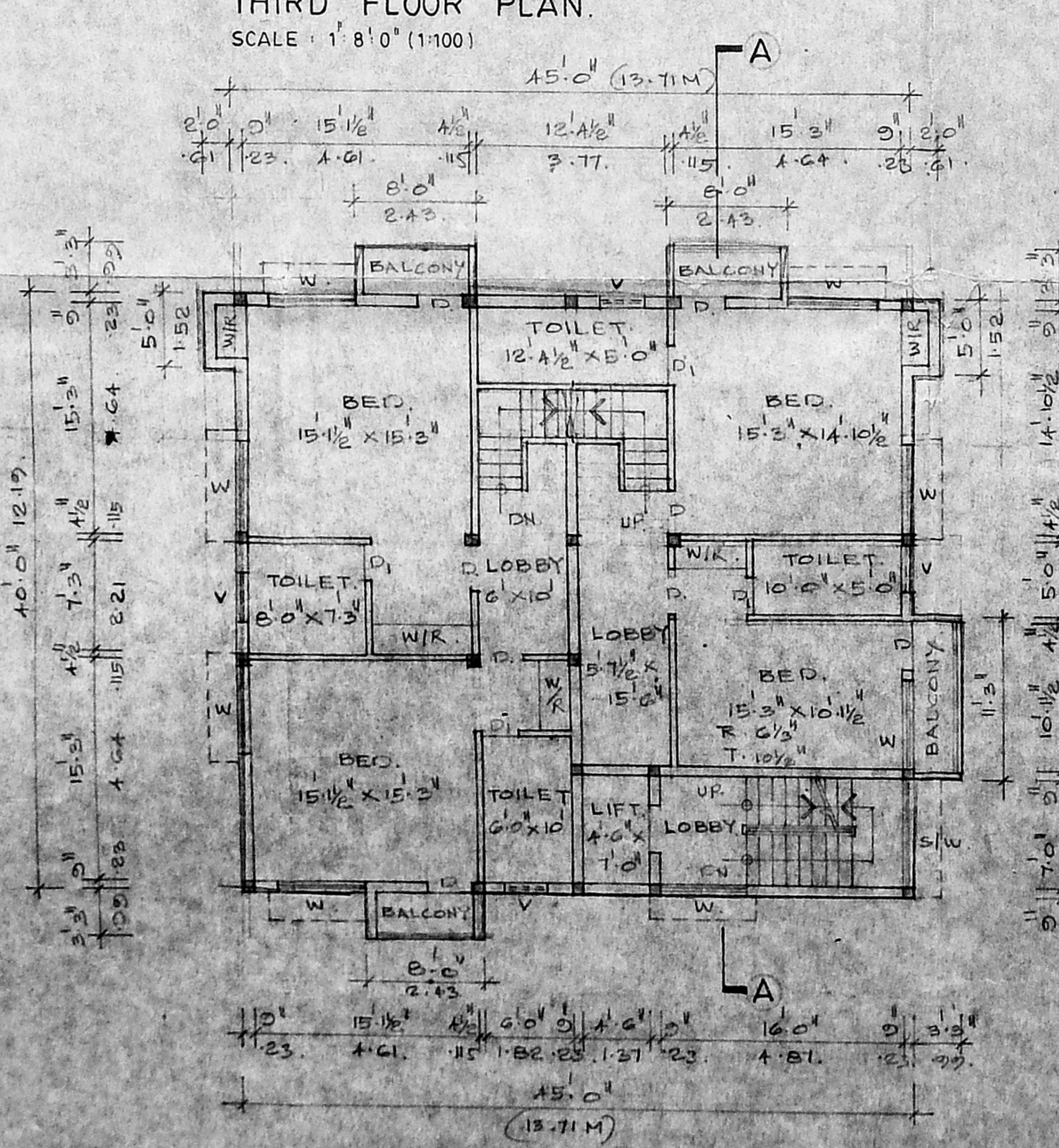

SECOND FLOOR PLAN
SCALE: 1" = 8' 0" (1:100)

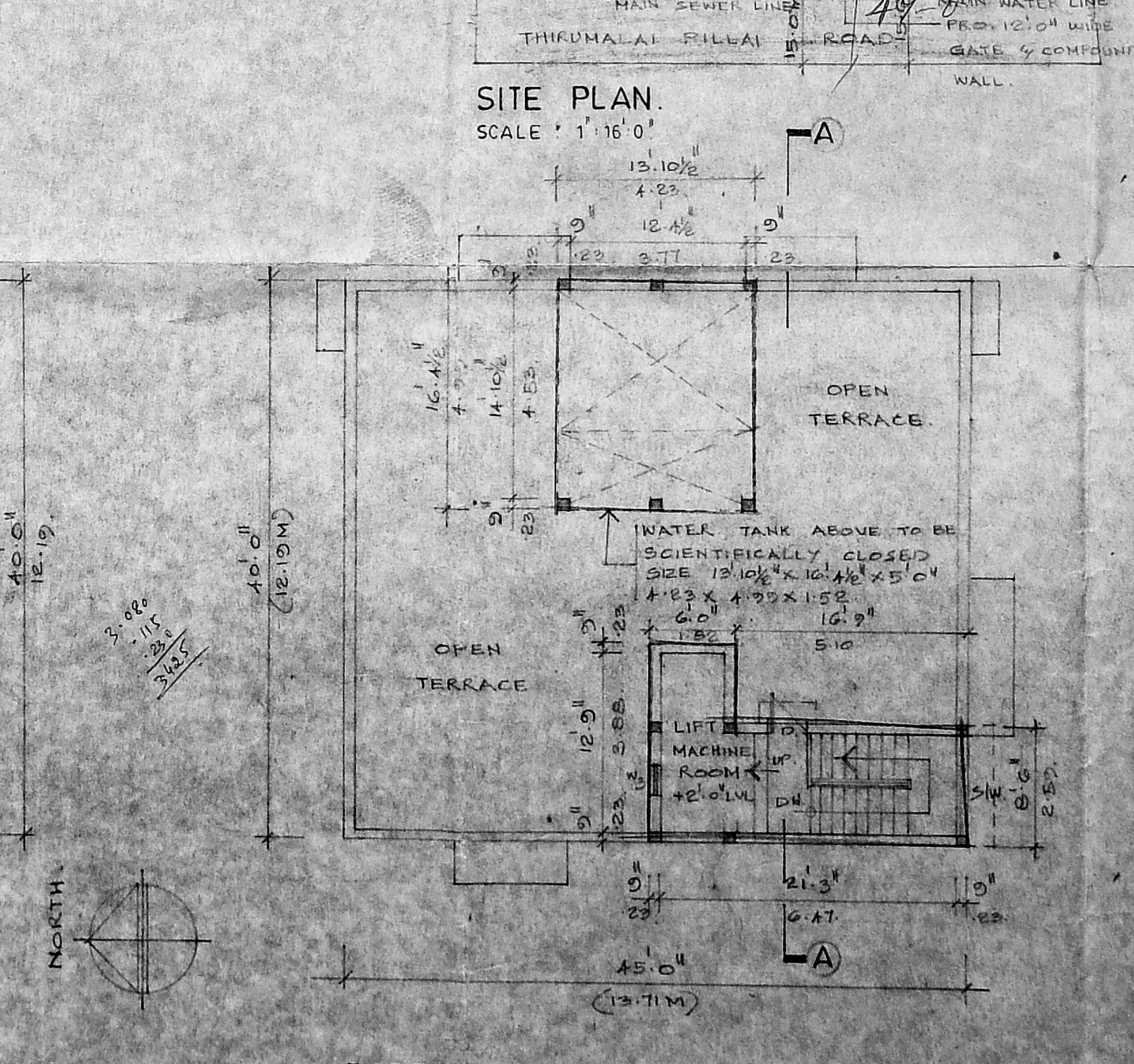

TERRACE FLOOR PLAN
SCALE: 1" = 8' 0" (1:100)

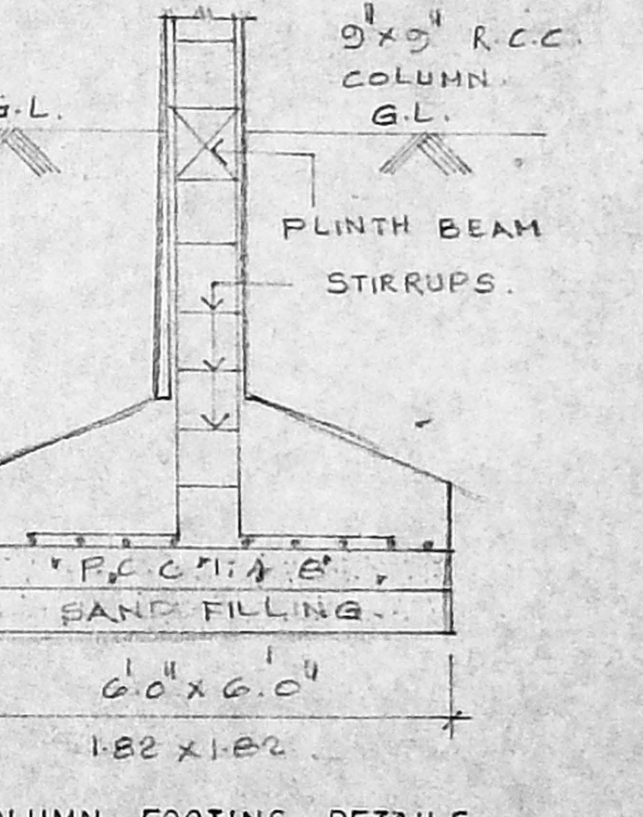

COLUMN FOOTING DETAILS
SCALE: 1" = 2' 0" (1:25)

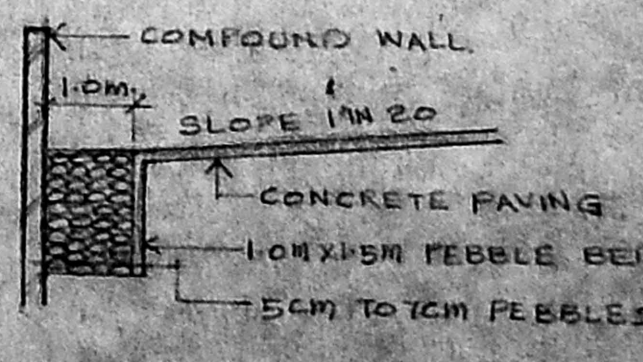

SECTION "YY" RAIN WATER HARVEST DETAILS
SCALE: 1" = 8' 0" (1:100)

SCHEDULE OF JOINTS			
TYPE	WIDTH	HEIGHT	DESCRIPTION
M.D.	2'-0"	7'-0"	MAIN DOOR
D.	2'-0"	7'-0"	FLUSH DOOR
P.	2'-0"	7'-0"	DO
D.W.	2'-0"	7'-0"	DOOR CASE WINDOW
W.	2'-0"	7'-0"	GLAZED WINDOW
W ₂	4'-0"	4'-0"	DO
K.W.	6'-0"	3'-0"	KITCHEN WINDOW
S.W.	7'-0"	3'-0"	STAIR CASE WINDOW
V.	3'-0"	2'-0"	GLAZED VENTILATOR
W ₃	2'-0"	4'-0"	GLAZED WINDOW
R.S.	12'-0"	7'-0"	ROLLING SHUTTER

SPECIFICATIONS

FOUNDATION: COLUMN FOOTING FOUNDATION OVER A LAYER OF 1:1:8 V. SAND FILLING.

SUPER STRUCTURE: R.C.C. FRAME WORK WITH BRICK WORK IN CM 1:6.

R.C.C. WORKS: R.C.C. ROOF SLAB, R.C. LINTELS, SUNSHADES AND BEAMS IN R.C.C. WITH SUITABLE REINFORCEMENTS.

FLOORING: CEMENT FLOORING.

PLASTERING: PLASTERING IN CM 1:6 AND FINISHED WITH CEMENT PAINT.

WEATHERING: BRICK JELLY LIME CONCRETE COURSE LAID IN SLOPE WITH CRAB OIL FINISHED WITH TERRACE TILES.

NOTE: WELL TO BE HERMETICALLY SEALED AND SUMP AND O.H.T. TO BE SCIENTIFICALLY CLOSED.

COLOR CODE REFERENCE

- PROPOSED WORK
- EXISTING ROAD
- BOUNDARY LINE
- WATER LINE
- SEWER LINE

SIGNATURE OF OWNER

G. SELVARAJAN, P. ARCH., I.C.E. (INDIA)
REGISTERED ARCHITECT NO. 218
CARRIAGE WAY, MADRAS
1, SARANGAPANI STREET,
MADRAS-600 017

SIGNATURE OF ARCHITECT

PROPOSED RESIDENTIAL BUILDING - NEW DOOR
NO. 10, THIRUMALAI FILLAI ROAD, NAGAR,
NAGAR, MADRAS 17, T.S. NO. 8321 & 8322,
BLOCK NO. 109

FLOOR PLANS, SECTION, ELEVATION, JOB NO. & DATE
& SITE PLAN, ETC.
SCALE: 1" = 8' 0" (1:100)

ARCHITECTS:
SELVARAJAN & ASSOCIATES
1, SARANGAPANI ST., NAGAR, MADRAS